

AERODROME CHART - ICAO

ARP  
N47 29 20  
E021 36 55  
AERODROME ELEV 361

DEBRECEN INFO 125.910  
BUDAPEST INFORMATION (EAST) 133.000

DEBRECEN

RWY	DIRECTION	THR	BEARING	STRENGTH	TORA	TODA	ASDA	LDA
04R	042°	N47 28 53, E021 36 11	PCN 53/R/B/W/T		2500	2500	2500	2500
22L	222°	N47 29 41, E021 37 29	PCN 53/R/B/W/T		2500	2500	2500	2200
04L	NIL - UNDER CONSTRUCTION							
22R	NIL - UNDER CONSTRUCTION							

Apron	PCN 44/R/B/W/T
Taxiway: A	PCN 42/R/B/W/T
Taxiway: B	PCN 60/R/B/W/T
Taxiways width: 18 m.	

LIGHTING

RWY 04R/22L

**Approach:** Cat. I, high intensity (900 m) on THR 04R.  
**Threshold:** High intensity green uni- and bidirectional, RWY identification flashing lights on THR 22L.  
**PAPI:** 3.00° (MEHT: see in chart).  
**Runway edge:** High intensity white/yellow uni- and bidirectional (2500 m), spacing: 60 m on THR 04R. Red/white/yellow uni- and bidirectional (2500 m), spacing: 60 m on THR 22L.  
**Runway end:** High intensity red uni- and bidirectional.

Geoid undulation 41 m 136 ft

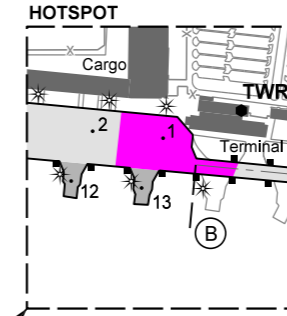

CAUTION: **APRON and Taxiway B.** Pay extra attention to moving vehicles and taxiing aircraft.

LEGEND

- Earth rampart, shelter
- VISUAL AIDS**
- Approach lighting barrette
- PAPI
- Threshold identification flashing light
- High intensity uni- and bidirectional RWY lights (edge, threshold, end)
- Retroreflective TWY edge marker
- Flood lighting

FOR BASIC CHART SYMBOLS SEE GEN 2.3.

APRON ELEVATION: NOT AVAILABLE.  
GEOGRAPHICAL COORDINATES FOR TWY CENTRE LINES: NOT AVAILABLE.  
OBSTACLES TO TAXIING: NOT AVAILABLE.

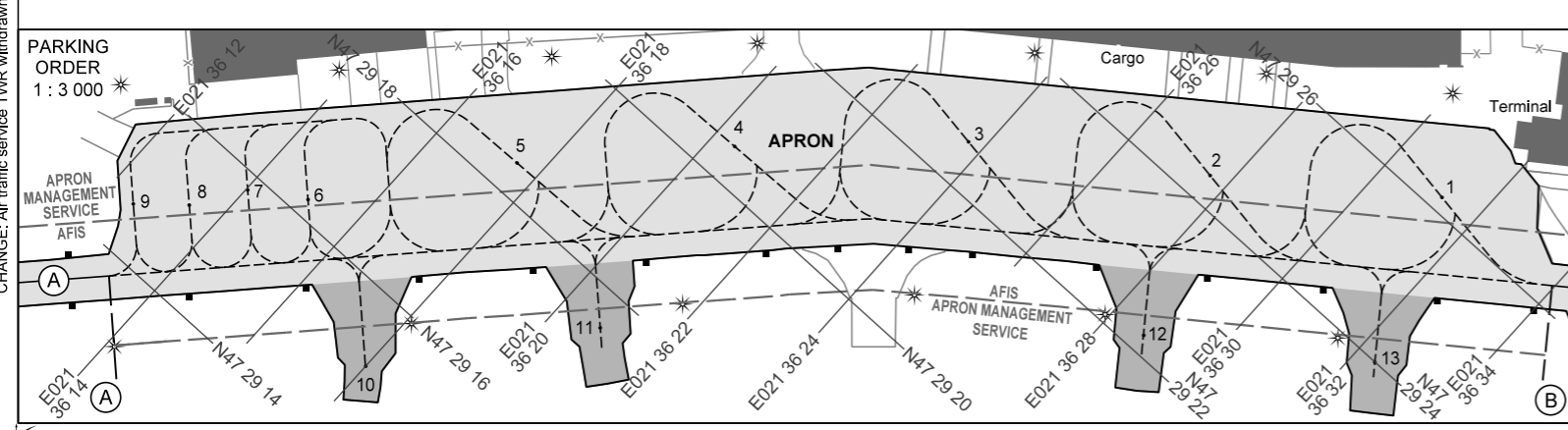
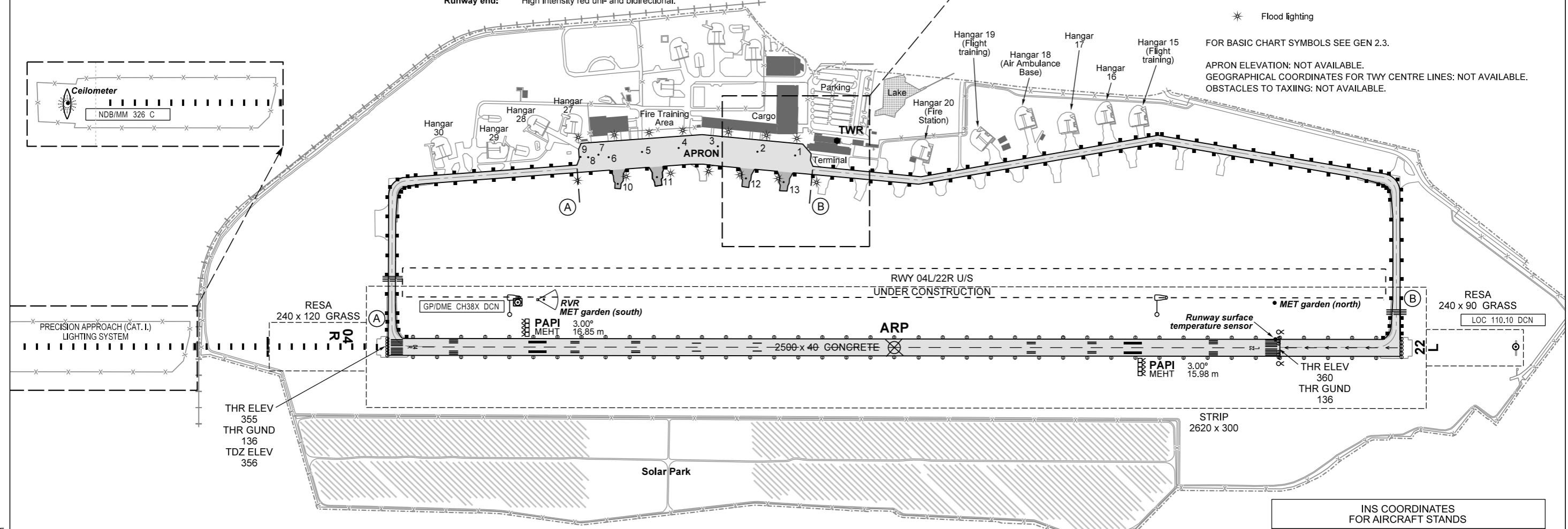

INS COORDINATES FOR AIRCRAFT STANDS		
STANDS	INS COORDINATES	AIRCRAFT ICAO CAT
1	N47 29 26.20, E021 36 31.30	C
2	N47 29 24.40, E021 36 27.70	C
3	N47 29 22.60, E021 36 23.80	C
4	N47 29 20.40, E021 36 20.50	C
5	N47 29 18.20, E021 36 17.60	C
6	N47 29 16.10, E021 36 15.10	B (MAX WS 21 m)
7	N47 29 15.70, E021 36 14.00	A
8	N47 29 15.00, E021 36 13.30	B
9	N47 29 14.60, E021 36 12.60	A (MAX WS 12 m)
10	N47 29 15.00, E021 36 18.00	A
11	N47 29 17.50, E021 36 20.90	A
12	N47 29 22.20, E021 36 28.80	A
13	N47 29 24.00, E021 36 32.40	A

**NOTE:**  
**MET garden (south) contains:** Anemometer, Wind direction sensor, Barometer, Temperature and Humidity Sensor  
**MET garden (north) contains:** Anemometer, Wind direction sensor

ELEVATIONS ARE IN FEET  
DIMENSIONS ARE IN METRES  
BEARINGS ARE MAGNETIC

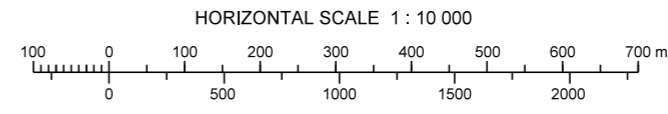

CHANGE: Air traffic service TWR withdrawn

THIS PAGE IS INTENTIONALLY LEFT BLANK