

BUDAPEST APP	122.975	BUDAPEST TOWER	118.100	BUDAPEST APRON	122.440
	123.860	BUDAPEST GROUND	121.910	ATIS	132.380
	119.510	BUDAPEST DELIVERY	134.540	ATIS (BUD VOR)	117.300
BUDAPEST INFORMATION (NORTH)			119.350		

BUDAPEST/LISZT FERENC
APRON 2

AIRCRAFT PARKING/DOCKING CHART - ICAO

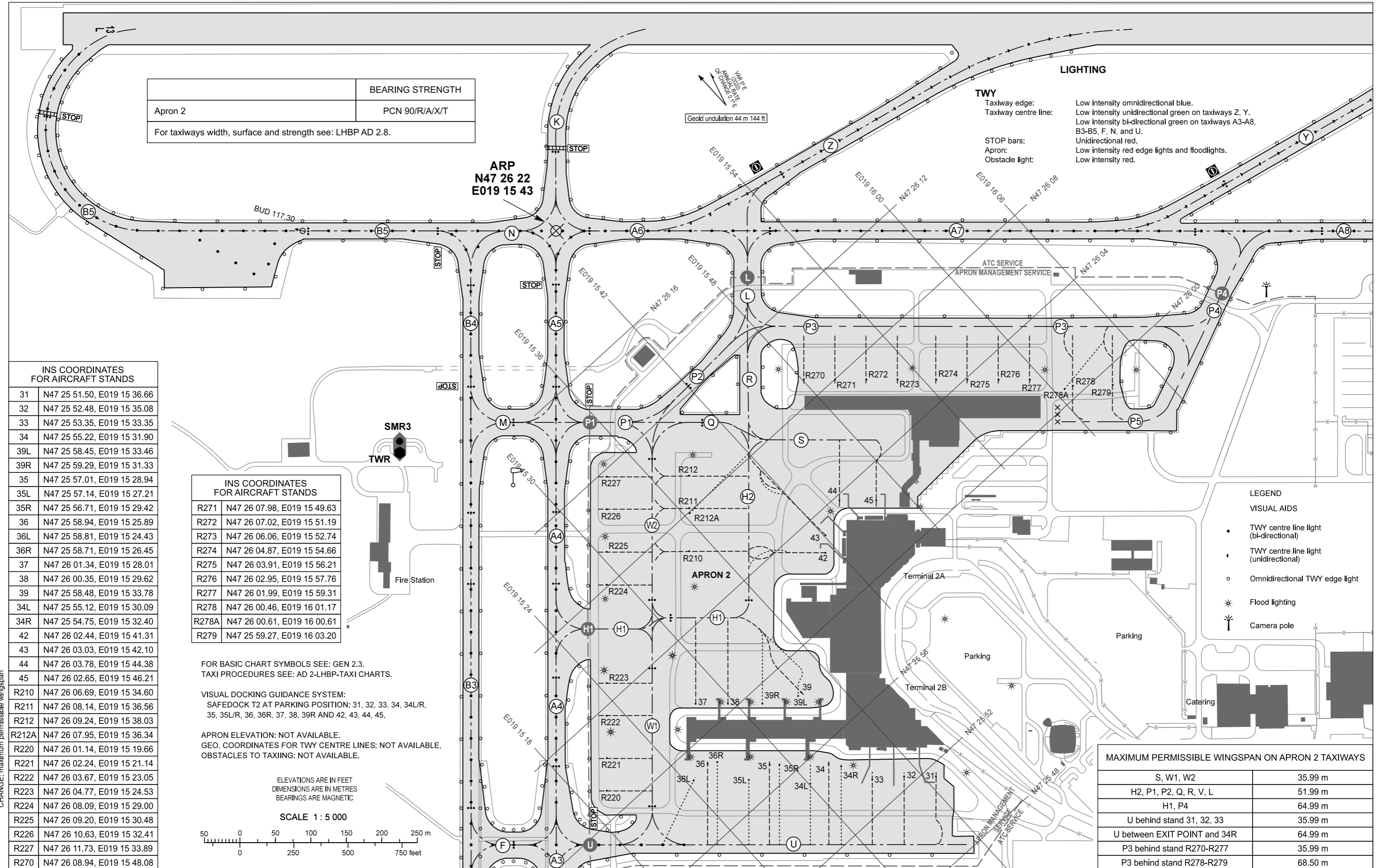

	BEARING STRENGTH
Apron 2	PCN 90/R/A/X/T
For taxiways width, surface and strength see: LHBP AD 2.8.	

LIGHTING

TWY
Taxiway edge: Low intensity omnidirectional blue.
Taxiway centre line: Low intensity unidirectional green on taxiways Z, Y, B3-B5, F, N, and U. Low intensity bi-directional green on taxiways A3-A8.

STOP bars: Unidirectional red.
Apron: Low intensity red edge lights and floodlights.
Obstacle light: Low intensity red.

INS COORDINATES FOR AIRCRAFT STANDS

31	N47 25 51.50, E019 15 36.66
32	N47 25 52.48, E019 15 35.08
33	N47 25 53.35, E019 15 33.35
34	N47 25 55.22, E019 15 31.90
39L	N47 25 58.45, E019 15 33.46
39R	N47 25 59.29, E019 15 31.33
35	N47 25 57.01, E019 15 28.94
35L	N47 25 57.14, E019 15 27.21
35R	N47 25 56.71, E019 15 29.42
36	N47 25 58.94, E019 15 25.89
36L	N47 25 58.81, E019 15 24.43
36R	N47 25 58.71, E019 15 26.45
37	N47 26 01.34, E019 15 28.01
38	N47 26 00.35, E019 15 29.62
39	N47 25 58.48, E019 15 33.78
34L	N47 25 55.12, E019 15 30.09
34R	N47 25 54.75, E019 15 32.40
42	N47 26 02.44, E019 15 41.31
43	N47 26 03.03, E019 15 42.10
44	N47 26 03.78, E019 15 44.38
45	N47 26 02.65, E019 15 46.21
R210	N47 26 06.69, E019 15 34.60
R211	N47 26 08.14, E019 15 36.56
R212	N47 26 09.24, E019 15 38.03
R212A	N47 26 07.95, E019 15 36.34
R220	N47 26 01.14, E019 15 19.66
R221	N47 26 02.24, E019 15 21.14
R222	N47 26 03.67, E019 15 23.05
R223	N47 26 04.77, E019 15 24.53
R224	N47 26 08.09, E019 15 29.00
R225	N47 26 09.20, E019 15 30.48
R226	N47 26 10.63, E019 15 32.41
R227	N47 26 11.73, E019 15 33.89
R270	N47 26 08.94, E019 15 48.08

INS COORDINATES FOR AIRCRAFT STANDS

R271	N47 26 07.98, E019 15 49.63
R272	N47 26 07.02, E019 15 51.19
R273	N47 26 06.06, E019 15 52.74
R274	N47 26 04.87, E019 15 54.66
R275	N47 26 03.91, E019 15 56.21
R276	N47 26 02.95, E019 15 57.76
R277	N47 26 01.99, E019 15 59.31
R278	N47 26 00.46, E019 16 01.17
R278A	N47 26 00.61, E019 16 00.61
R279	N47 25 59.27, E019 16 03.20

FOR BASIC CHART SYMBOLS SEE: GEN 2.3.
TAXI PROCEDURES SEE: AD 2-LHBP-TAXI CHARTS.

VISUAL DOCKING GUIDANCE SYSTEM:
SAFEDOCK T2 AT PARKING POSITION: 31, 32, 33, 34, 34L/R, 35, 35L/R, 36, 36R, 37, 38, 39R AND 42, 43, 44, 45.

APRON ELEVATION: NOT AVAILABLE.
GEO. COORDINATES FOR TWY CENTRE LINES: NOT AVAILABLE.
OBSTACLES TO TAXIING: NOT AVAILABLE.

ELEVATIONS ARE IN FEET
DIMENSIONS ARE IN METRES
BEARINGS ARE MAGNETIC

SCALE 1 : 5 000

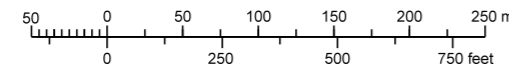

LEGEND

VISUAL AIDS

- TWY centre line light (bi-directional)
- TWY centre line light (unidirectional)
- Omnidirectional TWY edge light
- * Flood lighting
- † Camera pole

MAXIMUM PERMISSIBLE WINGSPAN ON APRON 2 TAXIWAYS

S, W1, W2	35.99 m
H2, P1, P2, Q, R, V, L	51.99 m
H1, P4	64.99 m
U behind stand 31, 32, 33	35.99 m
U between EXIT POINT and 34R	64.99 m
P3 behind stand R270-R277	35.99 m
P3 behind stand R278-R279	68.50 m

CHANGE: maximum permissible wingspan

THIS PAGE IS INTENTIONALLY LEFT BLANK