

TAXI PROCEDURES FOR DEPARTING AIRCRAFT - INDEX CHART
INDEX CHART

BUDAPEST/LISZT FERENC

TAXI ROUTING BEFORE TAKE-OFF

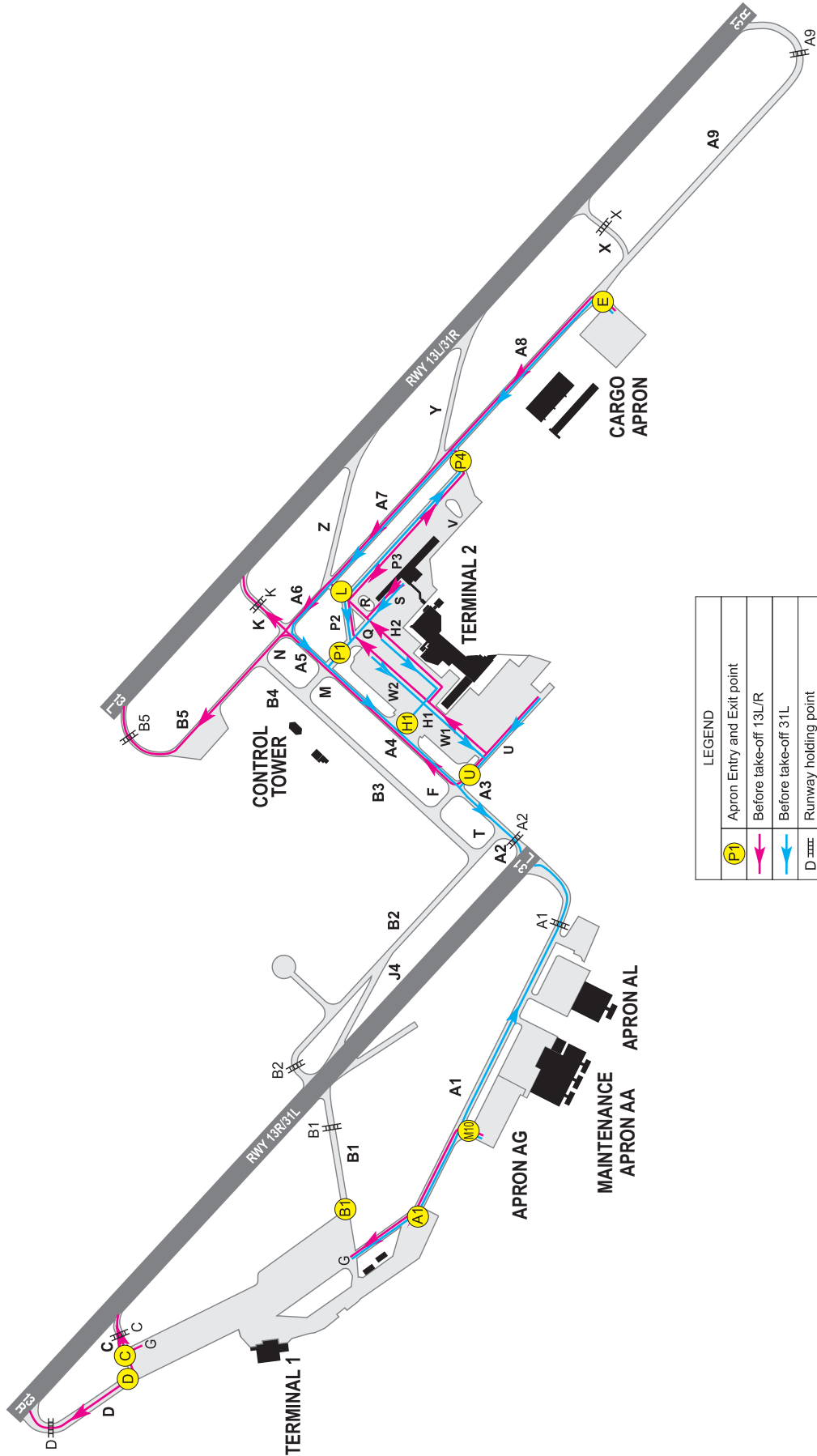

LEGEND	
	Apron Entry and Exit point
	Before take-off 13L/R
	Before take-off 31L
	Runway holding point

CHANGE: Construction site updated, new hangar (CODE E)

**AD 2 LIST OF AVAILABLE TAXI CLEARANCES FOR DEPARTING AIRCRAFT
ISSUED BY ATC**

Departures on RWY	From stands/gates	EXIT POINTS	Taxi route on Apron(taxilane or TWY segments) to be followed	HOLDING POINTS	Taxi route on the maneuvering area (TWY segments) to be followed	Terminal	Remarks			
13L	31 - 36L	U	U	K or B5 on request	U-A4-A5-K or U-A4-A5-N-B5	2	H1 or P1 after coordination; Code D, E, F exit U only			
	42 - 43	L	H1/H2-R-L		L-A6-K or L-A6-N-B5		* H1 after coordination; Code E exit H1 only			
	37 - 39L*									
	R270 -R277							P3-L	P1 or P4 after coordination	
	R210 - R212A R224 - R227							W2-P1	L after coordination; R212A push back only to H2	
	44 - 45							S-Q-P1	Code D, E exit P4 only	
	R220-R223							W1-H1		
	R278 - R279	P4	V-P4		P4-A7-A6-K or P4-A7-A6-N-B5					
C1, C1L/R, C2, C2L/R	E	E	E-A8-A7-A6-K or E-A8-A7-A6-N-B5	CARGO APRON						
13R	R101 - R107 G150 - 172 R110 - R117A	C	G	C	1	Code E, F exit B1 only				
		D		D						
	G130 - G141	M10	Apron taxilane	C D	A1-(G)-C A1-(G)-D	APRON AG				
31L	31 - 36L	U	U	A2	U-A3-A2	2	R212A push back to H2 and P1 or L exit only by Follow Me			
	R220 - R223		W1-U							
	37 - 39L	H1	H1		H1-A4-A3-A2					
	42 - 43		H2-H1							
	R210 - R212A R224 - R227		W2-H1							
	44 - 45	P1	S-Q-P1		P1-A4-A3-A2			P4 after coordination		
	R270 - R277		P3-P2-P1							
	R278 - R279	P4	V-P4		P4-A7-A6-A5-A4-A3-A2					
	R101-R108 G150-G172 R110-R117A	A1	G		A1			A1	1	Code D, E, F exit B1 only
	G130 - G141	M10	Apron taxilane		A1 or B1 on request			A1 or B1	APRON AG	
C1, C1L/R, C2, C2L/R	E	E	A2	A8-A7-A6-A5-A4-A3-A2*	CARGO APRON	* Max. Code E				