

ARP  
N47 37 38  
E017 48 30  
AERODROME ELEV 426

PÉR INFO 129.910  
BUDAPEST INFORMATION (WEST) 125.500

GYÖR/PÉR

AERODROME CHART - ICAO

RWY	DIRECTION	THR	BEARING STRENGTH	TORA	TODA	ASDA	LDA
12	116°	N47 37 58, E017 47 36	PCN 50/F/C/W/T	2030	2030	2130	2030
30	296°	N47 37 26, E017 49 00	PCN 50/F/C/W/T	2030	2030	2130	2030
Apron 1			PCN 45/R/C/W/T				
Apron 2			-				
Apron 3			PCN 61/R/C/W/T				
Taxiway: A			PCN 50/F/C/W/T				
Taxiways: A1, A2			PCN 44/F/C/W/U				
Taxiway: B			-				
Taxiway width: A: 15 m; A1, B: 7.5 m; A2: 10.5 m.							

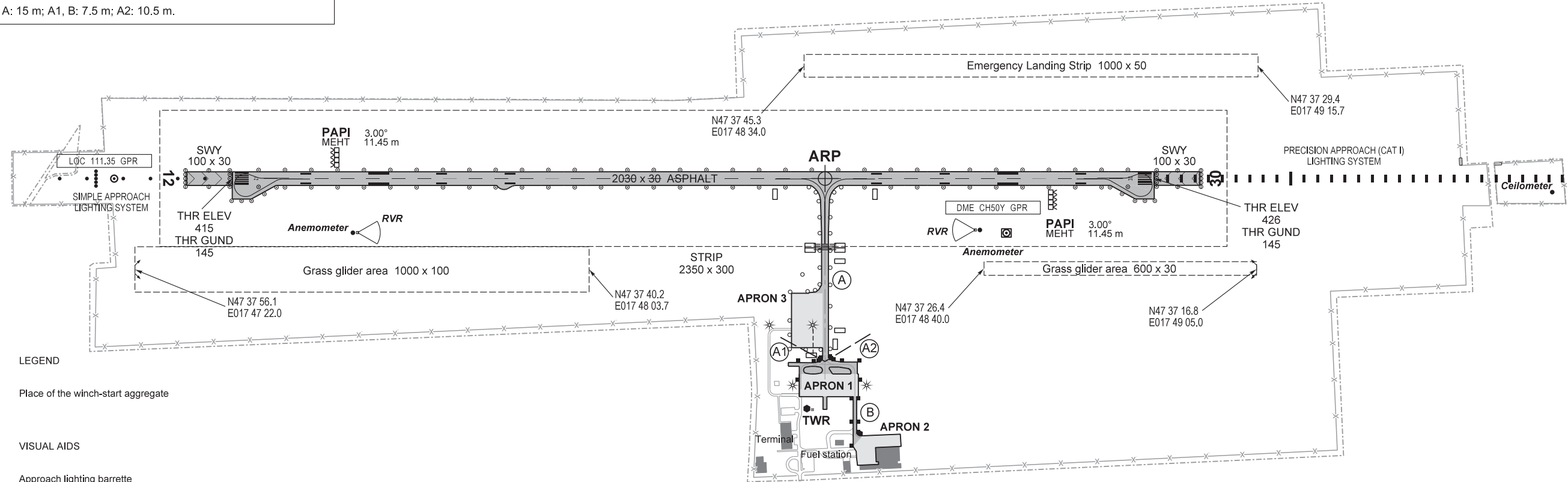

- LEGEND**
- ) Place of the winch-start aggregate
- VISUAL AIDS**
- | Approach lighting barrette
  - Approach light
  - ⊠ PAPI
  - RWY lights (edge, -threshold, -end)
  - Stopway lights
  - TWY edge marker
  - Retroreflective TWY edge marker
  - \* Flood lighting
  - Non illuminated taxiing guidance sign

**LIGHTING**

**RWY 12/30**  
**Approach:** Cat. I, high intensity (900 m) on THR 30, SALS medium intensity (420 m) on THR 12.  
**Threshold:** Green, 3.00° (11.45 m).  
**PAPI**  
**Runway edge:** High intensity white/yellow (2030 m), spacing: 58 m on THR 30, medium intensity white/yellow (2030 m), spacing: 58 m on THR 12.  
**Runway end:** Red.  
**Stopway:** Red (100 m).

ELEVATIONS ARE IN FEET  
DIMENSIONS ARE IN METRES  
BEARINGS ARE MAGNETIC

HORIZONTAL SCALE 1 : 10 000

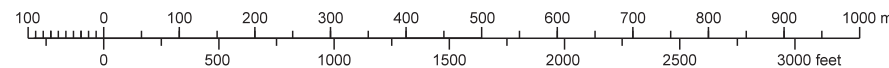

FOR BASIC CHART SYMBOLS SEE GEN 2.3.  
 AERODROME GUND: NOT AVAILABLE.  
 APRONS ELEVATION: NOT AVAILABLE.  
 GEOGRAPHICAL COORDINATES FOR TWY CENTRE LINES: NOT AVAILABLE.  
 OBSTACLES TO TAXIING: NOT AVAILABLE.  
 PARKING ORDER APRON 2: NOT AVAILABLE.  
 THE HIGHEST ELEVATION OF TDZ OF RWY 30: NOT AVAILABLE.

INS COORDINATES FOR AIRCRAFT STANDS	
1-7	NOT AVAILABLE

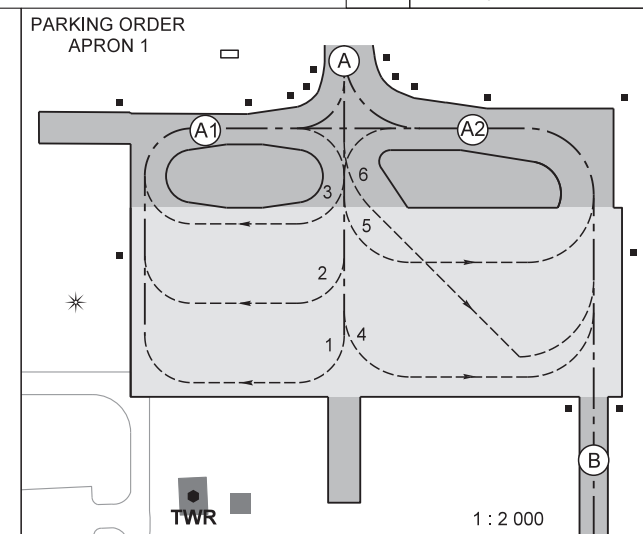
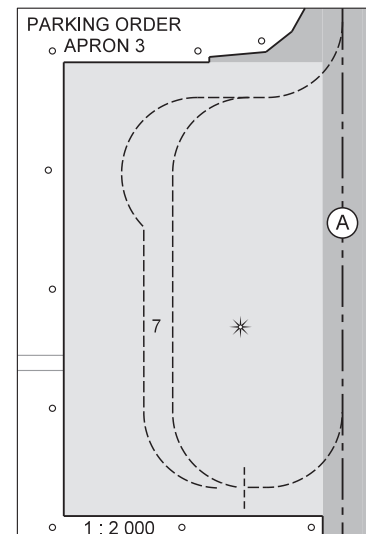

THIS PAGE IS INTENTIONALLY LEFT BLANK